

# BROTTON HALL & THE COURTYARD



Development of 2 & 3 bedroom houses and 1 & 2 bedroom apartments  
For more information tel: 01287 201286

## Location

The courtyard is located behind Broton Hall which is a grade 2 listed building.

The development is only a mile from the victorian coastal resort of Saltburn and only a short drive to the North Yorkshire moors and Whitby.

## Our Developments

The development consists of the following properties:

### Plots 1-5 & 14-18

A newly built stylish 2 bedroomed cottage located in the courtyard to the rear of Broton Hall.

### Plots 6-7 & 12-13

A newly built stylish 2 bedroomed apartment located in the courtyard to the rear of Broton Hall.

### Plots 8-11

A newly built stylish 3 bedroomed cottage located in the courtyard to the rear of Broton Hall set over 3 floors.

### Plot 19

A newly built stylish 2 bedroomed cottage located on the high street next to Broton Hall.

### Plot 20

A newly renovated stylish 2 bedroomed cottage located on the high street next to Broton Hall.

### Plots 21-22

Newly renovated 1 bedroomed apartments within Broton Hall.

### Plots 23-24

A spacious newly renovated 2 bedroomed apartment along side a 1 bedroomed apartment within Broton Hall.

### Plot 25

A newly renovated stylish 3 bedroomed cottage located on the high street next to Broton Hall.

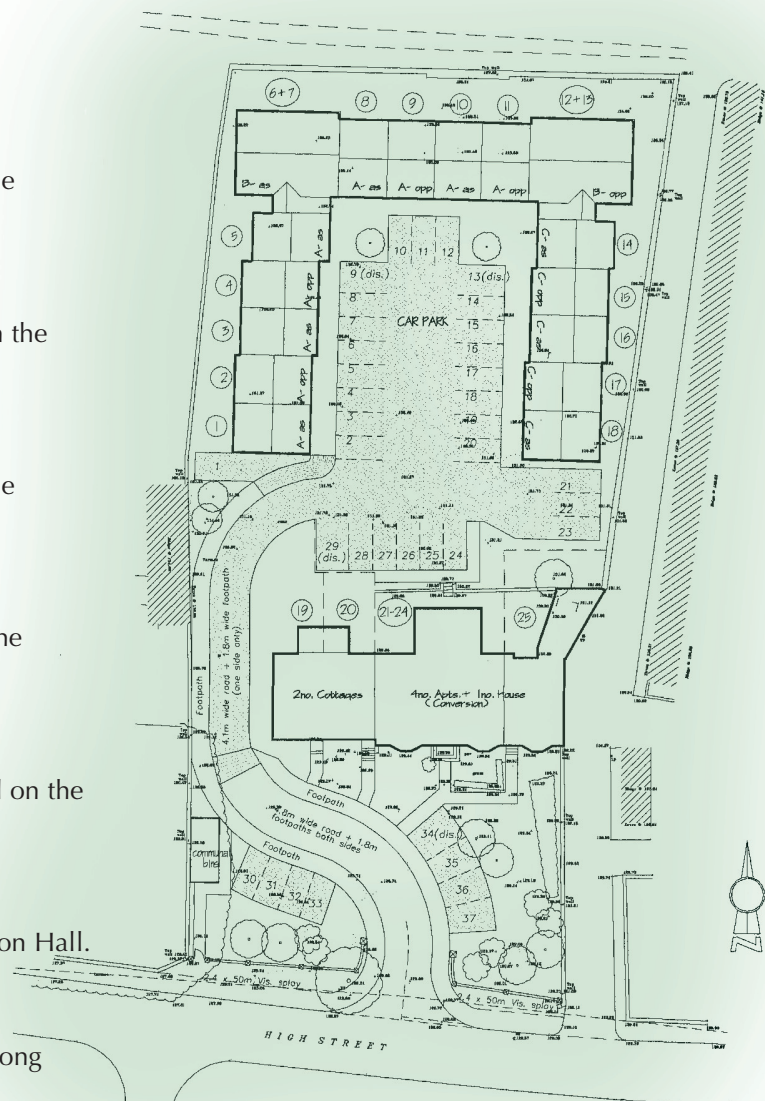

\* Floor plans only show approximate dimensions for a typical Westgate Home of its type. Within NHBC guidelines, the dimensions for a specific house may vary as each house is built individually.